

URBAN  
*Bonfire*<sup>™</sup>  
 URBAIN

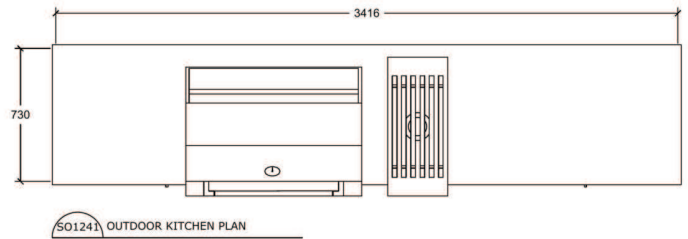

EVERY URBAN BONFIRE<sup>™</sup> OUTDOOR KITCHEN DESIGN INCLUDES:

- Thick Marine Grade Aluminum Construction
- Full Interior and Exterior Electrostatic Powder Coating
- Adjustable Commercial Grade 304 Stainless Steel Leveling Legs
- Matching Powder Coated Integrated Self-Leveling Toe Kick
- Compatibility with all Major Grill Brands and Outdoor Cooking Accessories
- Compatibility with Dekton, Sensa and Most Outdoor Countertop Surfaces
- 304 Stainless Steel Handles and Interior Hardware
- Ten-Year Limited Warranty

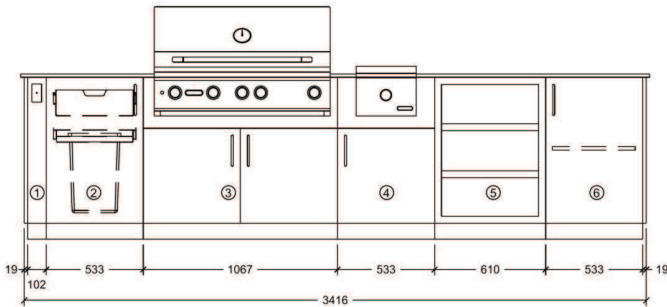

DESIGN CONSIDERATIONS:

- Powder Coating: Anthracite
- Handle Model: Stainless Steel
- Side Panels: 28.75"
- Back panels Included: Yes or No
- Countertop Thickness: ¾"
- Appliances: Bull grill, Bull side burner
- Gas Type: NG or Propane

Print Name: \_\_\_\_\_

Client Signature: \_\_\_\_\_

Date: \_\_\_\_\_

URBAN  
*Bonfire*<sup>™</sup>  
 URBAIN

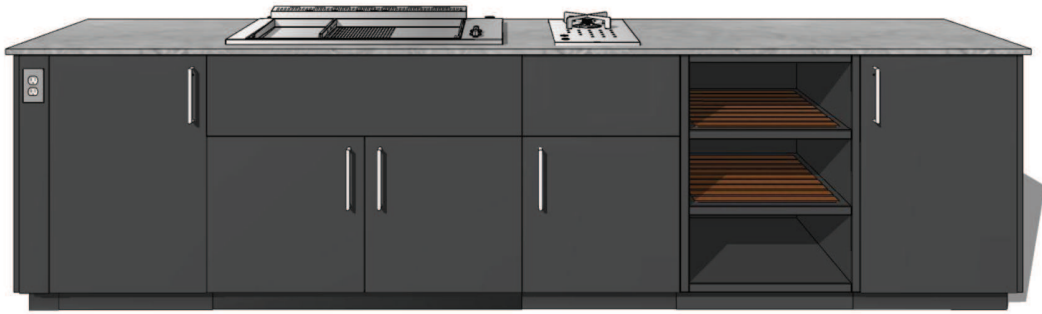

EVERY URBAN BONFIRE<sup>™</sup> OUTDOOR KITCHEN DESIGN INCLUDES:

- Thick Marine Grade Aluminum Construction
- Full Interior and Exterior Electrostatic Powder Coating
- Adjustable Commercial Grade 304 Stainless Steel Leveling Legs
- Matching Powder Coated Integrated Self-Leveling Toe Kick
- Compatibility with all Major Grill Brands and Outdoor Cooking Accessories
- Compatibility with Dekton, Sensa and Most Outdoor Countertop Surfaces
- 304 Stainless Steel Handles and Interior Hardware
- Ten-Year Limited Warranty

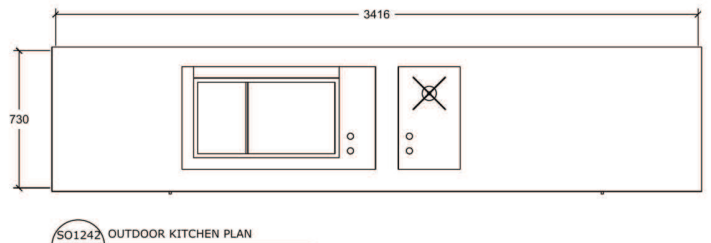
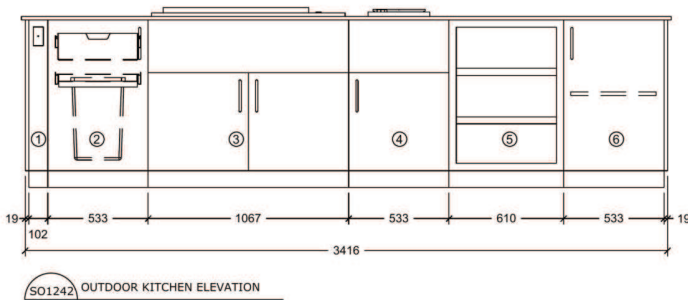

DESIGN CONSIDERATIONS:

- Powder Coating: Anthracite
- Handle Model: Stainless Steel
- Side Panels: 28.75"
- Back panels Included: Yes or No
- Countertop Thickness: 3/4"
- Appliances: Planet grill, Planet side burner
- Gas Type: NG or Propane

Print Name: \_\_\_\_\_

Client Signature: \_\_\_\_\_

Date: \_\_\_\_\_